



Forestry Chains and Steel Belt Descripton

FORESTRY CHAINS



With our chains ...

- We enable all forestry machines to operate in any terrain
- Are ideally suited to a wide range of applications, anywhere and anytime

Interforst



Allround Forestry Chain for every application

- Available with 13 mm chain and 14 mm stud or with 16 mm chain and 16 mm stud
- High traction
- Good self-cleaning
- Suitable for Forestry Machines and Tractors



Interforst

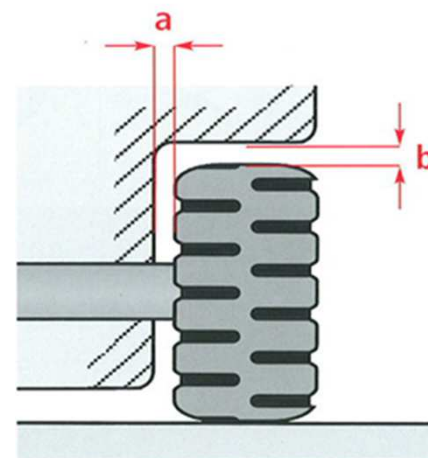
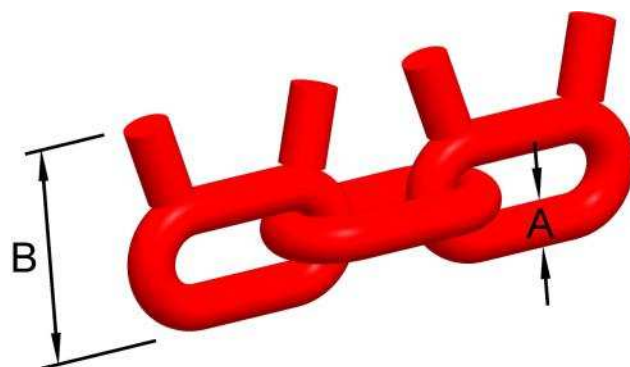

Size	A [mm]	B [mm]	Lock-System	Tensioning Chain	Min. Distance a / b [mm]
Interforst 13	Ø 13	63	C-Lock	without	75 / 90
Interforst 16	Ø 16	78	C-Lock	with	80 / 110

Taiga & Taiga Plus



Optimal combination of traction and tire protection chain

- Available with 14 mm connecting rings and 13 mm round steel chain or 16 mm connecting rings and 14 mm round steel chain
- Very high traction
- Very dense, double net chain mesh



Taiga
Welded stud



Taiga Plus
Forged stud

Taiga & Taiga Plus

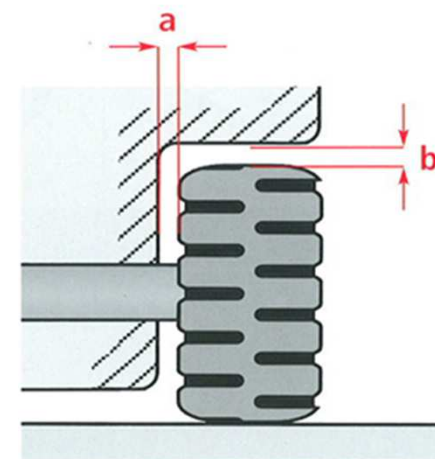

Size	A [mm]	B [mm]	C [mm]	Lock System	Tensioning Chain	Min. Distance a / b [mm]
Taiga 14	Ø 14,2	Ø 13	61	C-Lock	with	75 / 90
Taiga 14 Plus	Ø 14,2	Ø 13	57	C-Lock	with	75 / 90
Taiga 16	Ø 16	Ø 14	68	C-Lock	with	75 / 90
Taiga 16 Plus	Ø 16	Ø 14	68	C-Lock	with	75 / 100

Terra



Proven in professional forestry

- Available with 13 mm rings and 1 mm round steel chain or 16 mm rings and 13 mm round steel chain
- High running performance
- Forged wear links
- Good traction
- Good self-cleaning



Terra



A

B

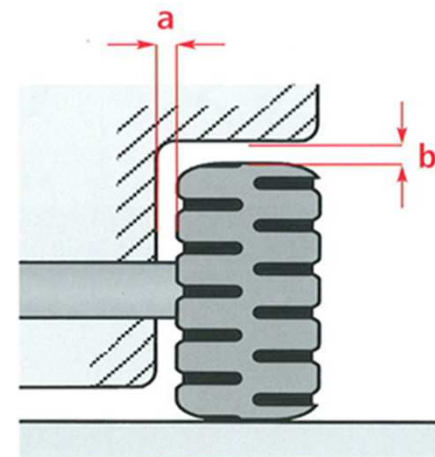
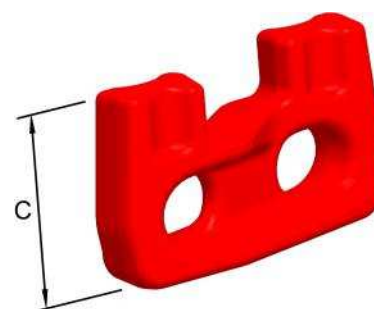

Size	A [mm]	B [mm]	C [mm]	Lock System	Tensioning Chain	Min. Distance a / b [mm]
Terra 13	Ø 13,2	Ø 10	55	Lock hook	with	50 / 90
Terra 16	Ø 16	Ø 13	55	Lock hook	with	75 / 90

T-Rex, T-Rex Plus & T-Rex Soft



Extremely strong in rough terrain

- Available with 14 mm connecting rings and 13 mm round steel chain or 16 mm connecting rings and 14 mm round steel chain
- Studs in 14 mm or 16
- Easy fitting



T-Rex
Welded Stud

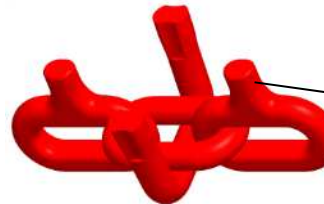

T-Rex Plus
Forged Stud (component)

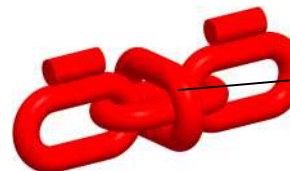

T-Rex Soft
Greifsteg and wear pin

T-Rex, T-Rex Plus & T-Rex Soft

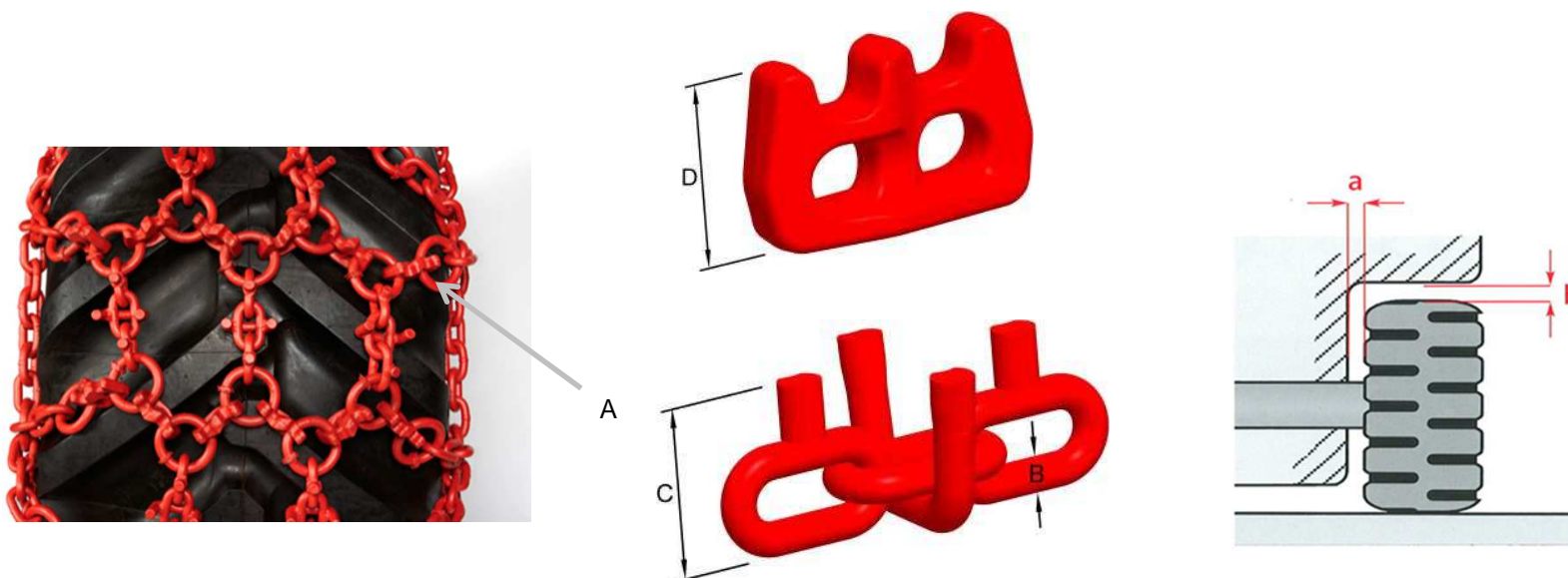

Size	A [mm]	B [mm]	C [mm]	D [mm]	Lock System	Tensioning Chain	Min. Distance a / b [mm]
T-Rex 14	Ø 14,2	Ø 13	61	49	C-Lock	without	75 / 90
T-Rex 14 Plus	Ø 14,2	Ø 13	57	49	C-Lock	without	75 / 90
T-Rex 14 Soft	Ø 14,2	Ø 13	56	49	C-Lock	without	75 / 80
T-Rex 16	Ø 16	Ø 14	68	54	C-Lock	without	75 / 100
T-Rex 16 Plus	Ø 16	Ø 14	68	54	C-Lock	without	75 / 100
T-Rex 16 Soft	Ø 16	Ø 14	61	54	C-Lock	without	75 / 90

Tetra



The alternative to the ring chain

- Available with 16 mm connecting rings and 13 mm round steel chain
- Good self-cleaning



Tetra

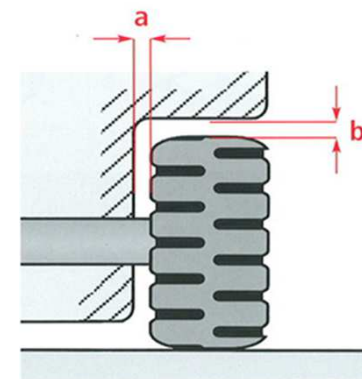
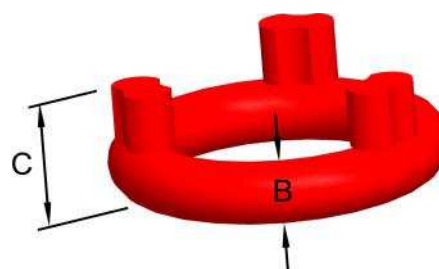

Size	A [mm]	B [mm]	C [mm]	D [mm]	Lock System	Tensioning Chain	Min. Distance a / b [mm]
Tetra 16	Ø 16	Ø 19	40	Ø 13	C-Lock	with	75 / 75

Highlander

Perfect traction in extreme terrain

- Round steel chain and connecting rin 19 mm
- Big ring stud thickness 28 mm
- For extreme applications



Highlander

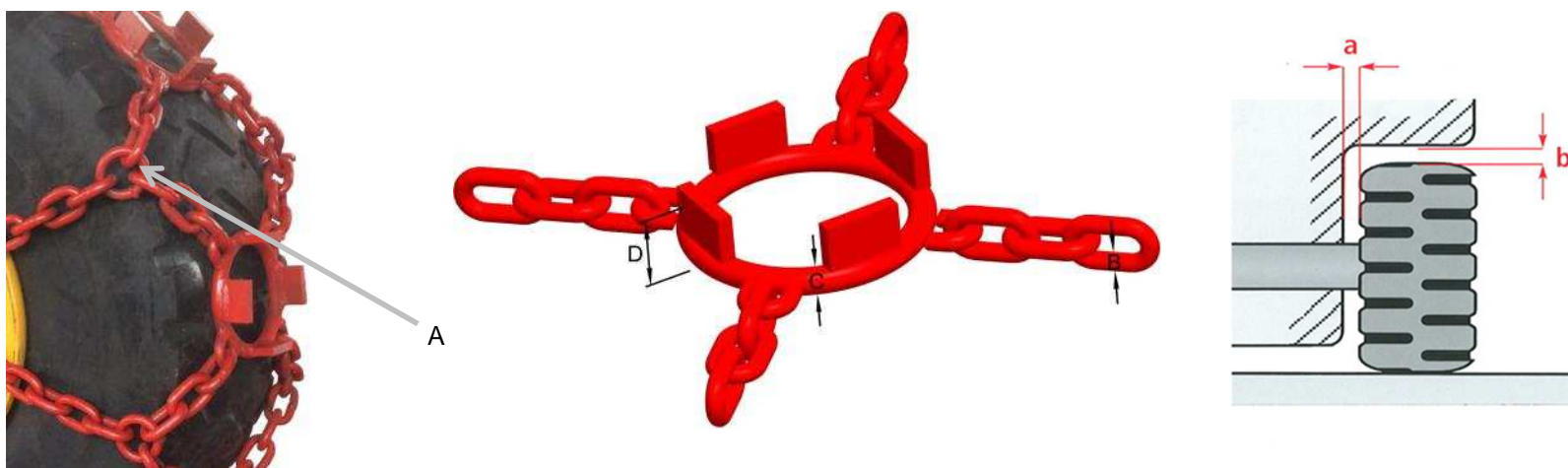

Size	A [mm]	B [mm]	C [mm]	D [mm]	Lock system	Tensioning Chain	Min. Distance a / b [mm]
Highlander	Ø 19	Ø 19	28	80	C-Schloss	ohne	90 / 120

Forestry chains für Bogie-Axles



- High traction due to specially designed track crosspieces - especially in steep terrain
- Good stability during riding across a slope
- Low weight with optimal traction
- Protect the machine and lower fuel consumption due to low weight compared to steel belt system
- Very good self-cleaning
- Very quiet running on hard and frozen surface
- In case of wear components can be replaced



Cornering grip
25 mm connection bolt

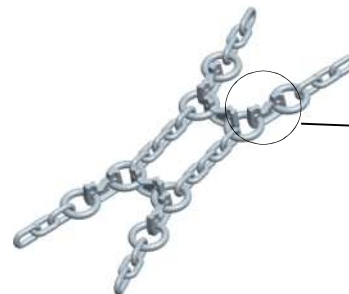

Spurkreuz
13 mm chain and
16 mm ring

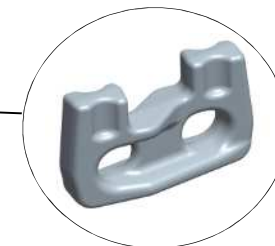

Forged link

Duetta

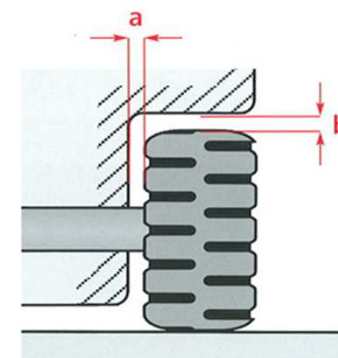
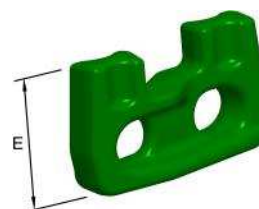
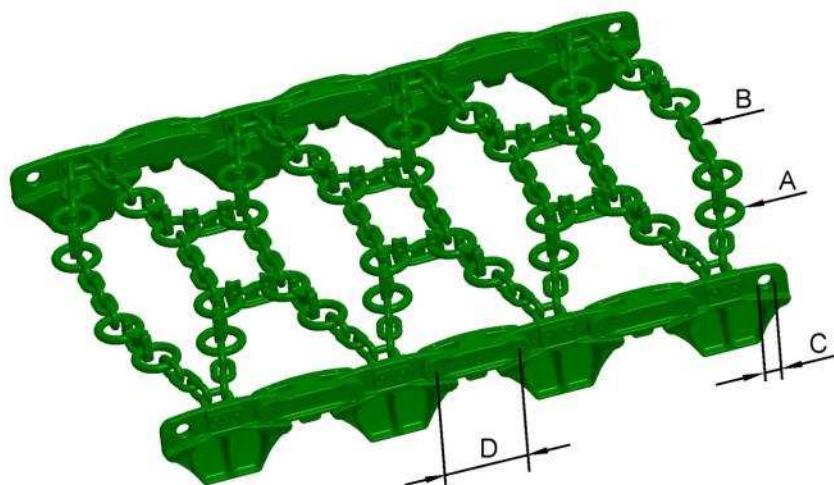

A [mm]	B [mm]	C [Ø mm]	D [mm]	E [mm]	Lock System	Tensioning Chain	Min. Distance a / b [mm]
Ø 16	Ø 13	Ø 25	150	55	C-Lock	without	100 / 100

Timber Track Business



Traction Steel Belt System

- For all Bogie forestry equipment
- 2 pikes per plate
- For very steep and difficult terrain

Delivery per Piece

- ✓ Complete steel belt system on 2 pallets (first assembly, a plate must be removed according to our experience → spare part)
- ✓ 12 short track locks (4 pieces pre-assembled)
- ✓ 4 track locks
- ✓ Fitting Clamp

Timber Track Business

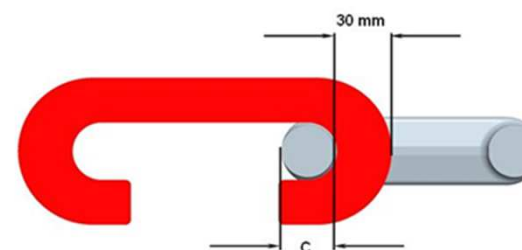
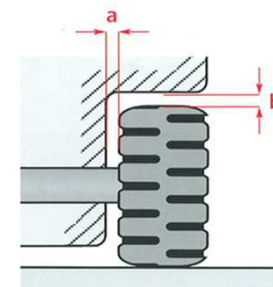
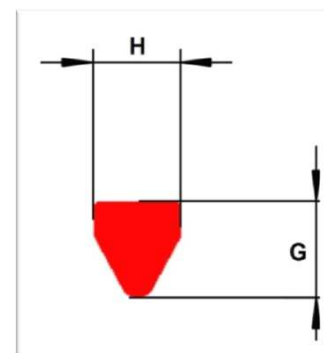
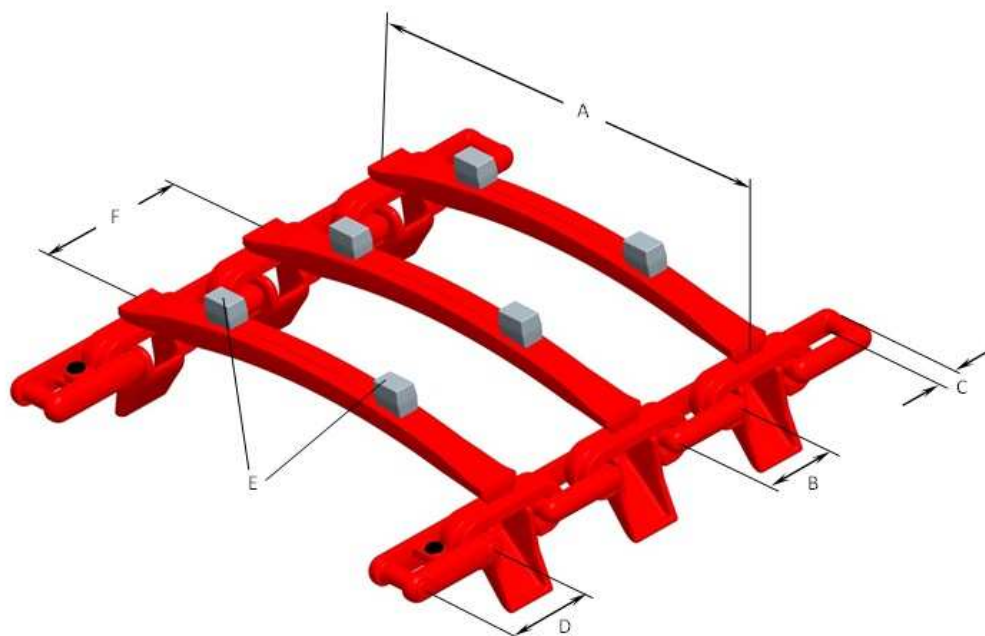

A* [mm]	B [mm]	C [Ø mm]	D [mm]	E [B / H / T; mm]	F [mm]	G [mm]	H [mm]	Min. Distance a / b [mm]
790	114	29	128 / 157	54 / 38 / 36	230	55	50	120 / 120

* Für Reifengröße 710/45-26.5

Timber Track First



Universal Steel Belt System

- For all Bogie forestry equipment
- 2 pikes per plate
- Low surface pressure
- For steep, wet and difficult terrain

Delivery per Piece

- ✓ Complete steel belt system on 2 pallets (first assembly, a plate must be removed according to our experience → spare part)
- ✓ 12 short track locks (4 pieces pre-assembled)
- ✓ 4 track locks
- ✓ Fitting Clamp

Timber Track First

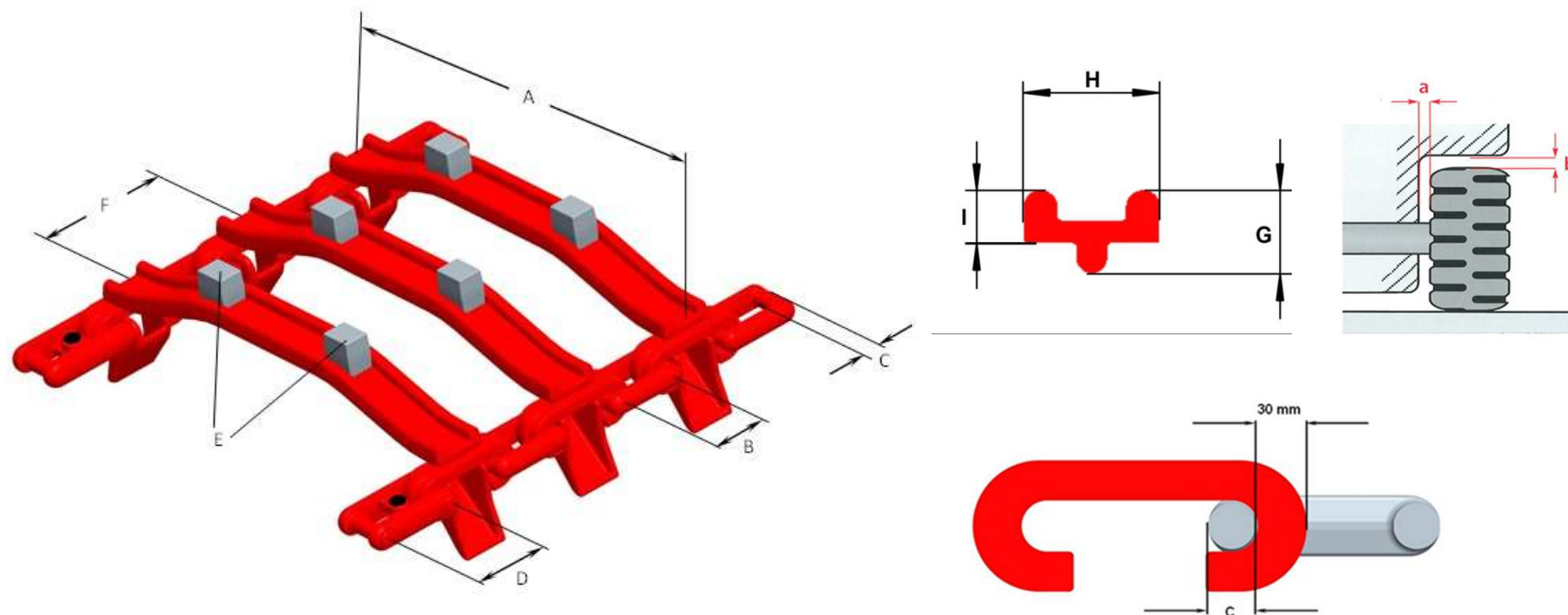

A* [mm]	B [mm]	C [Ø mm]	D [mm]	E [B / H / T; mm]	F [mm]	G [mm]	H [mm]	I [mm]	Min. Distance a / b [mm]
790	114	29	128 / 157	58 / 30 / 55	230	55	90	35	120 / 120

* Für Reifengröße 710/45-26.5

Timber Track Premium

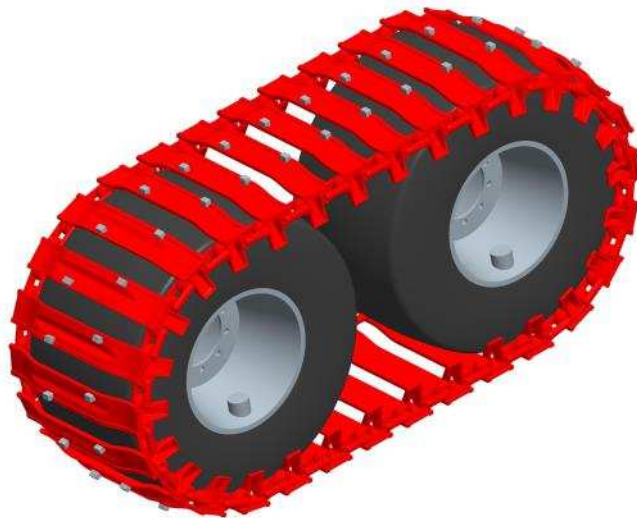

Steel Belt System for boggy terrain

- For all Bogie forestry equipment
- 2 pikes per plate
- Very low surface pressure
- For extreme boggy terrain

Delivery per Piece

- ✓ Complete steel belt system on 2 pallets (first assembly, a plate must be removed according to our experience → spare part)
- ✓ 12 short track locks (4 pieces pre-assembled)
- ✓ 4 track locks
- ✓ Fitting Clamp

Timber Track Premium

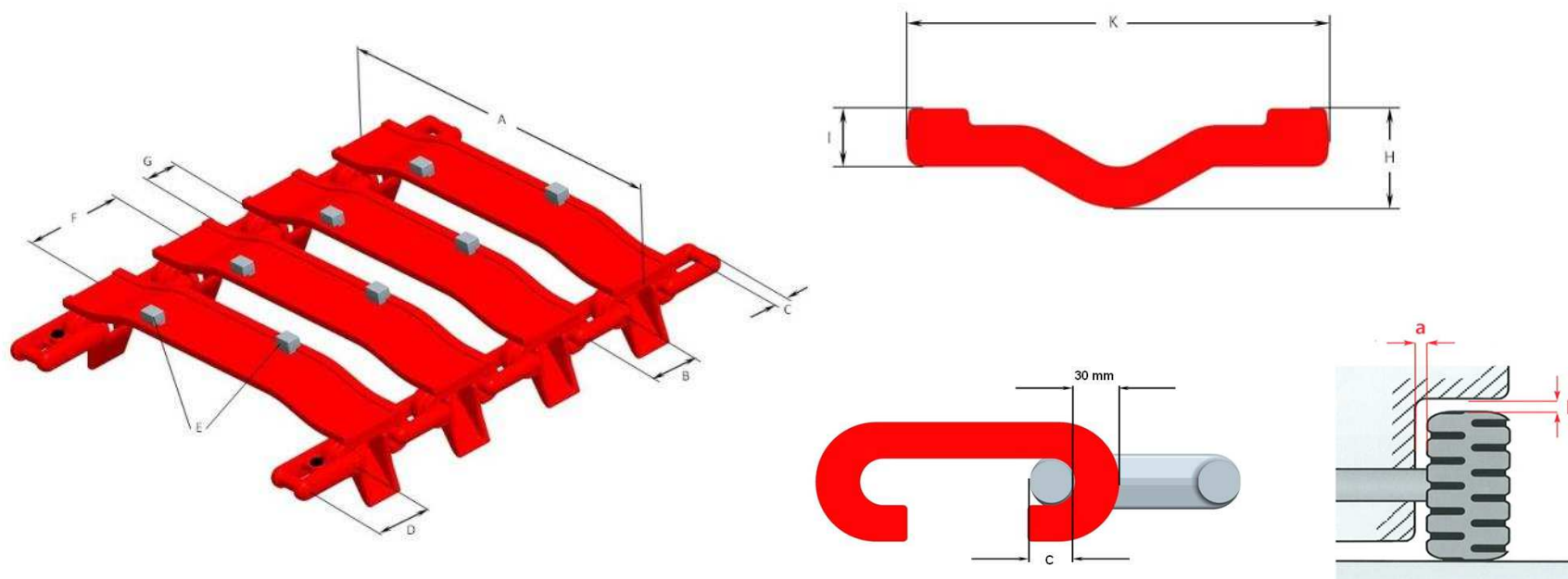

A* [mm]	B [mm]	C [Ø mm]	D [mm]	E [B / H / T; mm]	F [mm]	G [mm]	H [mm]	I [mm]	K [mm]	Min. Distance a / b [mm]
850	114	29	128 / 157	40 / 30 / 30	230	80	36	21	150	120 / 120

* Für Reifengröße 710/45-26.5

Timber Track Tensioning Equipment

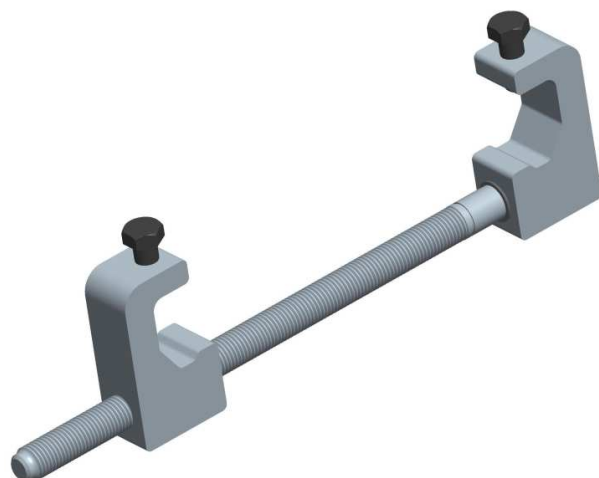

First & Business

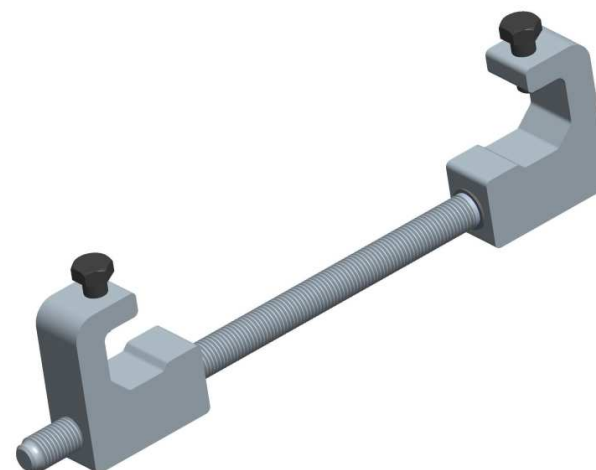

Premium